



Agriculture & Farming



Keep your dog on a lead at lambing

When walking your dog during the lambing season where stock is present, keep dogs on a lead when walking on Public Rights of Way, even though legislation only suggests keeping dogs under close control.

Dogs on access areas identified under the Countryside and Rights of Way Act need to be kept on a lead. In some cases dog exclusion notices have been served on sensitive areas — mainly relating to nesting birds. But if the owner is on a Public Right of Way crossing the access area the dog only needs to be under close control.

So why are farmers so concerned about dogs at lambing time? Apart from the obvious rogue dogs running wild and physically worrying and often killing sheep or causing them to abort, there are a number of reasons.

Movement of grazing stock

Lambing is the main harvest for the hill farmer and this time of year affects two-thirds of the farm's annual income so the farmer is doing everything to maximise the return from his ewes.

He has had them all scanned to check which ewes will produce twins and has separated these ewes and put them on better grazing, usually on an in-bye field which produces silage or hay later in the spring. As this type of grazing is limited the ewes with singles are returned to the hill where good grazing opportunities have been identified.

Good grazing is vital to the condition of the sheep up to and during lambing. The sheep will naturally move onto the areas where there is good grazing. If people walk through these areas the sheep tend to move elsewhere.

If you bring a dog into this

situation, especially off the lead, the behaviour of the sheep changes dramatically. They will move away at speed and flock together for protection. This rapid movement usually attracts the dogs' attention and the majority of dogs will follow their basic instinct and run after the sheep. This moves the sheep even further from the grazing area. It will take a long time for the sheep to resume grazing. If this is repeated, the sheep may be excluded from the grazing for some time. Restriction of grazing on top of constant movement will eventually affect the sheep's condition which could result in difficult births and underweight, weak lambs.

Disturbance during lambing

Running up to the moment of birth the ewe will pick her spot to lamb. This will be a quiet sheltered spot away from the main flock. If the ewe is disturbed it can cause complications and even the death of a half born lamb or in extreme cases the death of the ewe. The owner of a dog may be totally unaware that the dog has caused any problems. If disturbance happens just after the lamb has been born the ewe will rapidly move away from the dog leaving the lamb before bonding has begun. In some cases the ewe will lose interest and abandon the lamb to weather and predators.

Feeding

During lambing the farmer will continually monitor the ewes checking them through the day and night. As lambs are born he will spray a number on the lamb corresponding with the mother. This helps to match lamb to ewe to monitor feeding and motherly care. Good milk supply to the lamb is especially important over the first few days and becomes critical during bad weather. The only protection the lamb has from hypothermia is a good supply of milk. If disturbed, lambs become parted from mothers and feeding becomes erratic.

To supplement grazing the shepherd will feed food pellets in troughs to the ewes, and supply licks to provide nutrients and mineral supplements. During feeding the ewes push forward and compete for space along the troughs leaving lambs to mix and wander around. Following feeding the shepherd will ensure all lambs are paired with their mothers, at times physically picking up lambs and putting them back with the mother. This exercise is very important in bad weather and can be time consuming.

Imagine how the shepherd feels, especially after three days without sleep and it is pouring

with rain and sleet if

after all this effort and care he turns round to witness a dog causing mayhem amongst the paired flock. Even worse is if the event takes place just after the shepherd has left and lambs remain mixed, abandoned or lost until the next check later in the day!

So please keep your dog on a lead in areas near sheep.

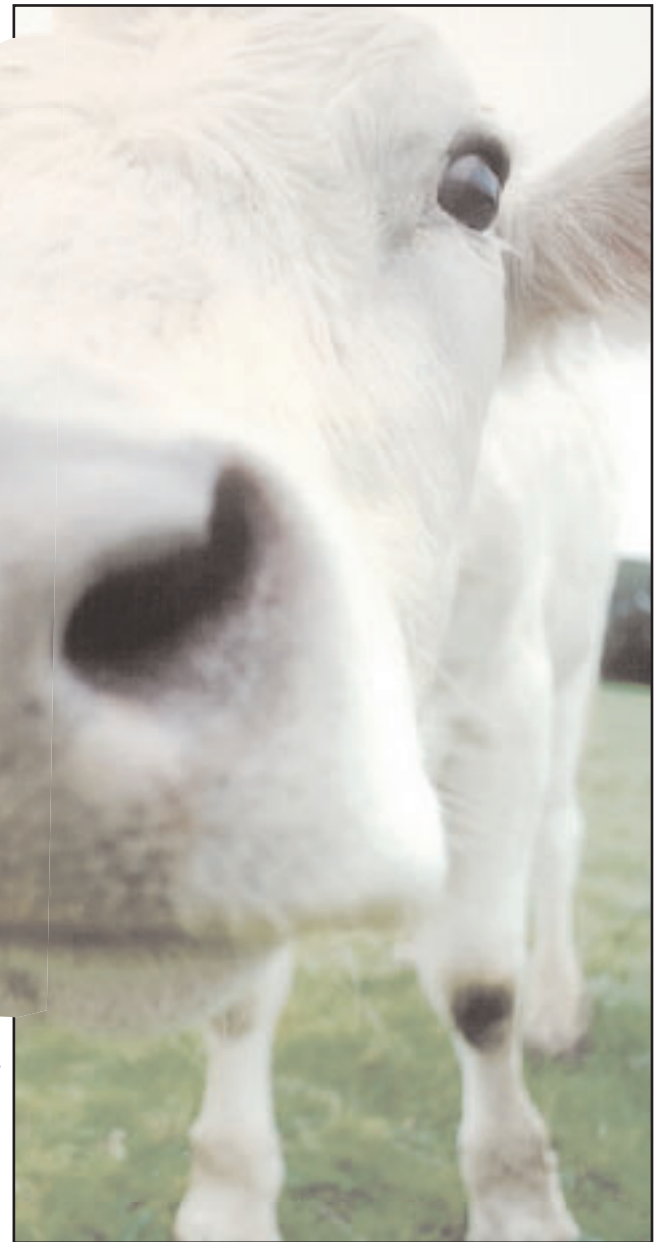

Hay-Good Lookin!

Introduction Agency

Exclusively for those involved in Agriculture or Equestrianism in South Wales.

For free details contact Diane on

07731 997 242 or email

haygoodlookin@hotmail.co.uk

www.haygoodlookin.co.uk

Riverside Supplies Ltd

STEEL ROOFING SHEETS

- Insulated Roof and Wall Panels
- Box profile / Corrugated Single skin sheets
- Fixings and PVC Guttering
- Flashings
- Rooflights
- Zed Purlins

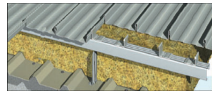

Glynmoch Yard, Glynmoch, Glanamman, Ammanford, Carmarthenshire SA18 2JF
Tel/Fax: (01269) 826255 • Mobile: 07971 162005
www.riverside-supplies.co.uk

ABERDEEN-ANGUS



The Blackacre Herd of Pedigree Aberdeen-Angus cattle has a selection of good young bulls for sale, ready to work, easy calving & with good temperament.
Stock Bulls:- Penguin Trendy Boy C142 EBV+25 (top 10% in the breed)
Rawburn Lord Rob F548 EBV+31 (top 5% in the breed)

Call John Biggs on 01994 241129

ROBERT EYNON & SON LTD

Golygfa, Beulah, Newcastle Emlyn SA38 9QN
(01239 - 810801)

- RAILWAY SLEEPERS • (WOOD & CONCRETE)
- CROSSING TIMBERS • NEW OAK SLEEPERS
- QUALITY SAWN SLEEPERS • (AS PLANKS)
- TELEGRAPH POLES • STEEL PIPES • (ALL SIZES)
- RAILWAY LINES • CRASH BARRIERS • (BOTH TYPES)

G. Thomas & Sons
Distributors of Petrol and Home Heating Oils

Suppliers of plastic fuel tanks

2 Pontarddulais Road, Tyeroes, Ammanford, Carmarthenshire, SA18 3QD

Tel: 01269 592437 • 01269 592681 • Fax 01269 596643



HUW EVANS AUCTIONEERS
www.huwevansauctioneer.co.uk

Servicing the farming community with professional advice and over 30 years experience

- Commercial & Pedigree Livestock Valuation & Sales by Auction and Private Treaty
- Sales of Valuation of Agricultural & Rural Properties
- Summer & Winter Grass Lettings & Tacking
- Single Farm Payment & Milk Quota Sales
- Agricultural Tenancy Negotiations & Advice
- Claims for damage by pipeline or other work

Sales Fixtures List and Weekly Update - Visit the Website

Contact Huw Evans on 07721 386617